



# **PSP-30B Ring Adapter Manual**

# Content

[Description](#)

[Package Contents](#)

[Mounting the Adapter on the Device](#)

[Mounting the Thermal Imaging Module on the Adapter](#)

[Legal Compliances and Disclaimers](#)

# Description

**PSP 30B** Adapters (SKU 79205) are designed to mount Krypton and Proton devices on the lenses of various daylight devices with an external lens diameter of 30 mm.

The bayonet connection allows you to quickly install and remove the thermal imaging module from the adapter.

The precise positioning mechanism enables the perfect alignment of a thermal imaging or night image in the field of view of daylight optics to achieve maximum viewing comfort.

# Package Contents

- PSP 30B Adapter
- Allen keys (S1.5, S4)
- User manual
- Warranty card

# Mounting the Adapter on the Device

<https://www.youtube.com/embed/9zMIPyf5Q9A>

---

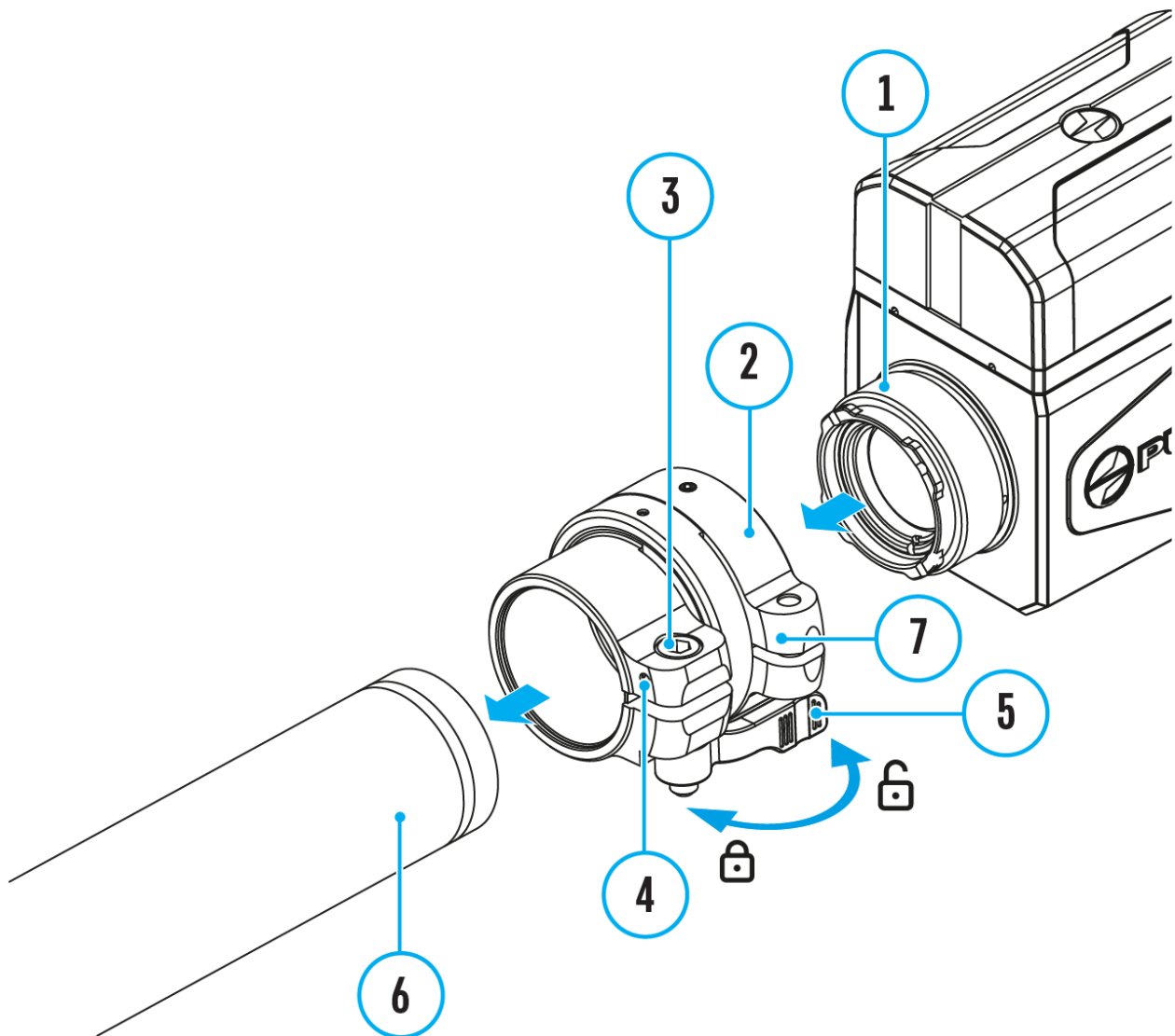

---

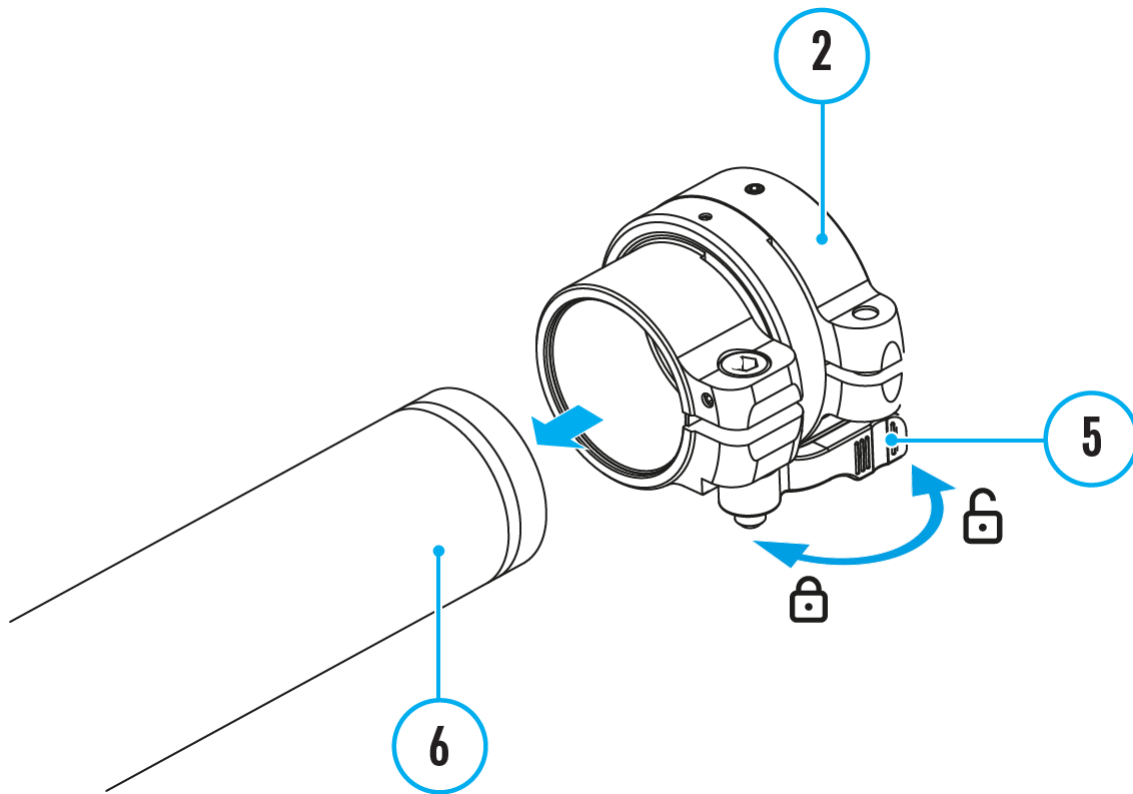

**Step 1. Mount the adapter on the optical device**

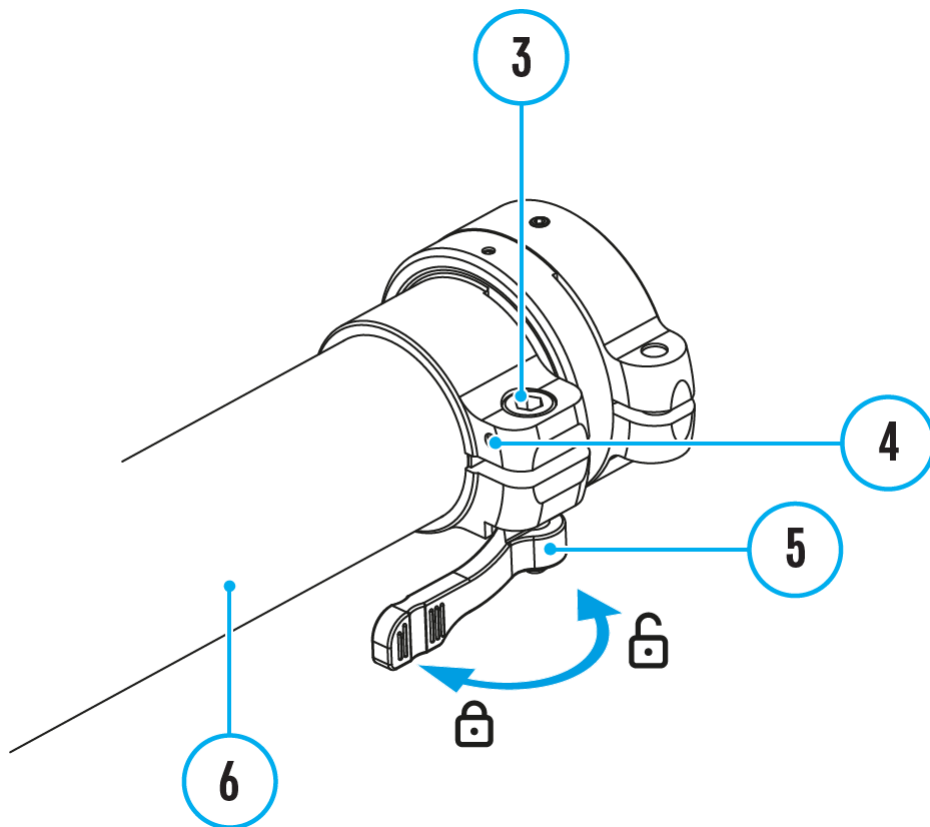

1. Move the lever **(5)** to the OPEN .
  2. It is recommended to degrease the lens body of the optical device **(6)** before installing the adaptor **(2)** onto the optical device.
  3. Mount the adapter **(2)** onto the lens of the optical device **(6)** as far as it will go.
- 

## Step 2. Adjust adapter lever



1. Move the lever **(5)** from its initial OPEN  position to the CLOSE .
2. Loosen the locking screw **(4)** with an Allen key ( $S = 1.5 \text{ mm}$ ).
3. Tighten the screw **(3)** with an Allen key ( $S = 4 \text{ mm}$ ). The clamping force should be  $1.5\text{-}2 \text{ N}\cdot\text{m}$  ( $13.3\text{-}17.7 \text{ in}\cdot\text{lbs}$ ) (can be checked with a torque screwdriver) to ensure tight operation of the lever **(5)**; while the adapter should not move relative to the body of the optical device **(6)**. If necessary, tighten or loosen the screw **(3)** to operate the lever **(5)** in the best way possible.
4. Tighten the locking screw **(4)** as far as it will go.

# Mounting the Thermal Imaging Module on the Adapter

**Step 1. Mount the thermal imaging module on the adapter**

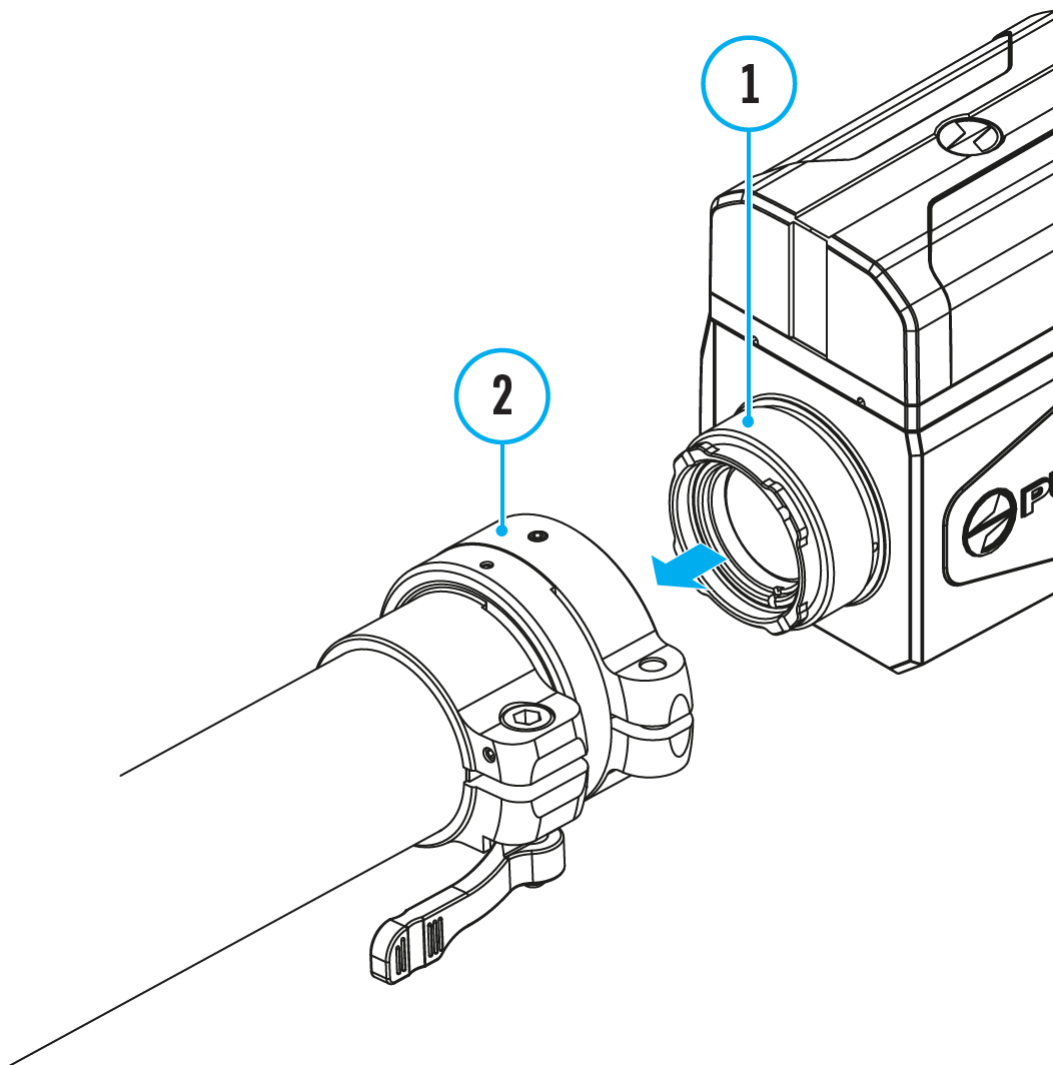

**1.** Remove the protective cover from the eyepiece of the thermal imaging module.

**2.** Align the protrusions on the adapter (**2**) with the grooves of the mount

assembly **(1)** of the thermal imaging module and turn the thermal imaging module counterclockwise as far as it will go.

---

## Step 2. Adjust the display position of the thermal imaging module

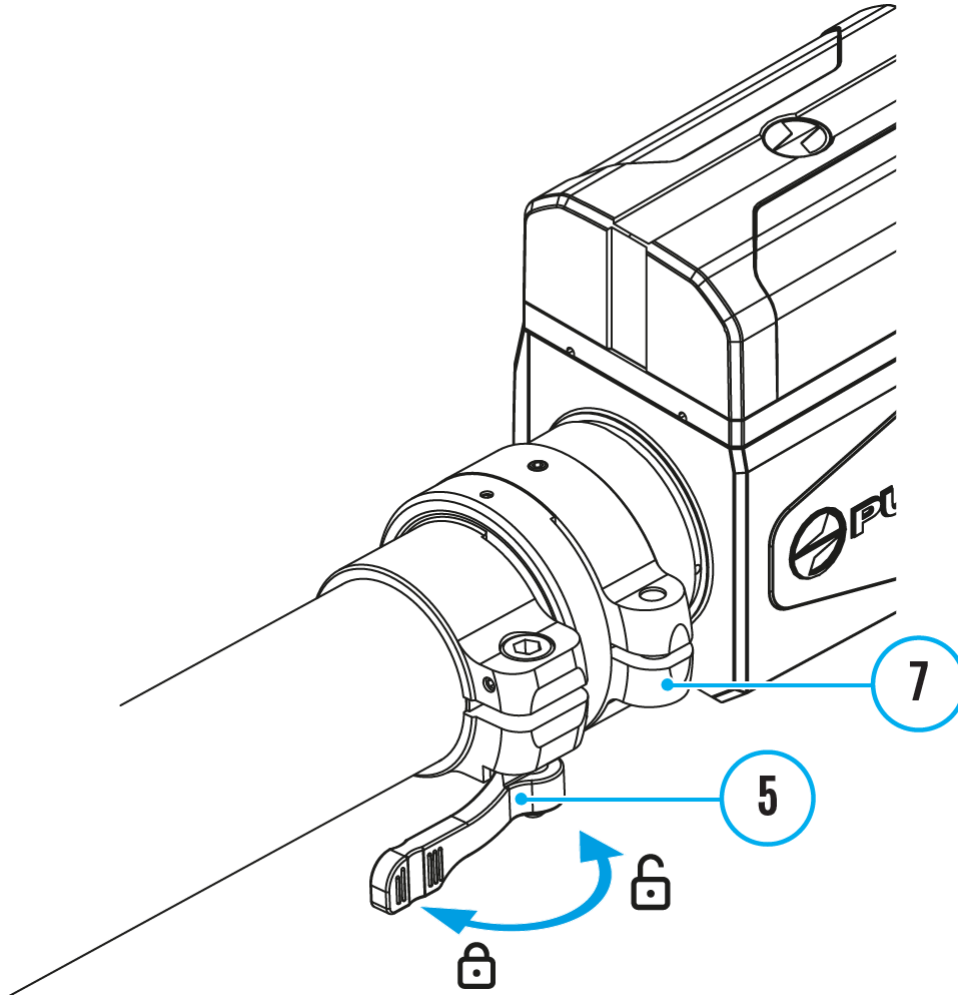

1. Loosen the screw **(7)** with an Allen key ( $S = 4\text{mm}$ ).
2. Turn on the thermal imaging module.
3. Align the image center on the display with the image center of the optical device by tilting the thermal imaging module.
4. Tighten the screw **(7)** as far as it will go. The clamping force should be  $5\text{ N}\cdot\text{m}$  ( $44.3\text{ in}\cdot\text{lbs}$ ) (use the torque screwdriver to check).
5. Move the lever **(5)** to the OPEN .
6. Align top and bottom display boundaries parallel to the horizontal axis by turning the adapter with thermal imaging module clockwise or

counterclockwise.

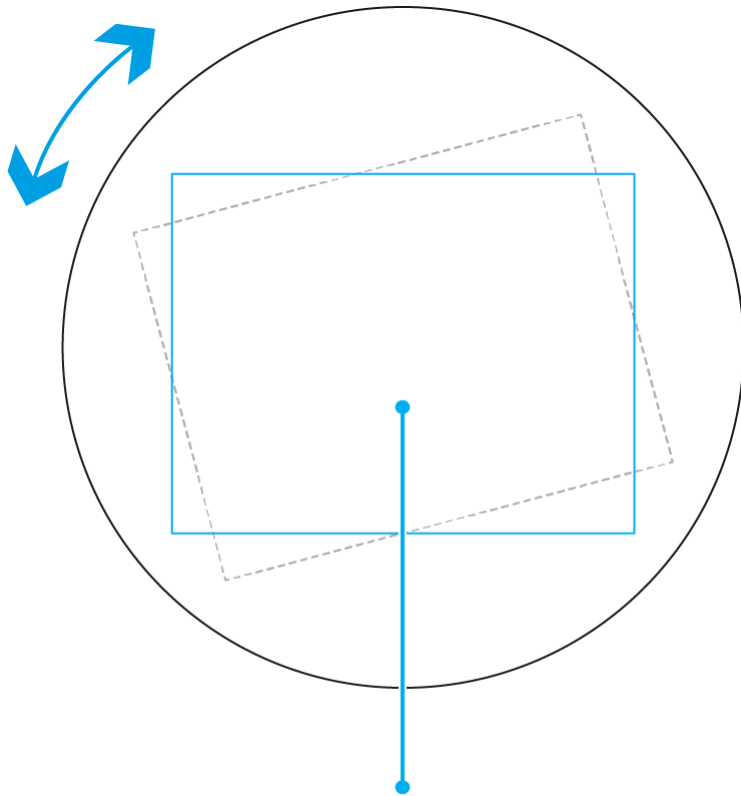

Display

7. Move the lever(5) to the CLOSE .

# Legal Compliances and Disclaimers

**Updates of the Product.** The manufacturer reserves the right at any time, without mandatory prior notice to the Customer, to make changes to the package contents (subject to the applicable laws, if any), design and characteristics that do not impair the quality of the Product.

**Limitation of Liability.** Subject to mandatory applicable laws and regulations: manufacturer will not be liable for any claims, actions, suits, proceedings, costs, expenses, damages or liabilities (if any), arising out of the use of this product. Operation and use of the product are the sole responsibility of the Customer. Manufacturer's sole undertaking is limited to providing the product(s) and related services in accordance with the terms and conditions of concluded transactions, including provisions established in warranty. The provision of products sold and services performed by Manufacturer to the Customer shall not be interpreted, construed, or regarded, either expressly or implied, as being for the benefit of or creating any obligation toward any third party (other than Distributor, Dealer, Buyer). Manufacturer's liability hereunder for damages, regardless of the form or action, shall not exceed the fees or other charges paid to Manufacturer for the product(s) and/or service(s).

MANUFACTURER WILL NOT BE LIABLE FOR LOST REVENUES OR INDIRECT, SPECIAL, INCIDENTAL, CONSEQUENTIAL, EXEMPLARY, OR PUNITIVE DAMAGES, EVEN IF THE MANUFACTURER KNEW OR SHOULD HAVE KNOWN THAT SUCH DAMAGES WERE POSSIBLE AND EVEN IF DIRECT DAMAGES DO NOT SATISFY A REMEDY.

---

For technical support please contact [support@pulsar-vision.com](mailto:support@pulsar-vision.com).

Answers to frequently asked questions about the devices can also be found in the **FAQ** section.